

Northgate Ped/Bike Bridge



Seattle Pedestrian Advisory Board
Rachel McCaffrey, Outreach Lead
Eric Birkhauser, VIA Architecture
June 14, 2017



Seattle
Department of
Transportation

Our mission, vision, and core values

Mission: deliver a high-quality transportation system for Seattle

Vision: connected people, places, and products

Committed to **5 core values** to create a city that is:

- Safe
- Interconnected
- Affordable
- Vibrant
- Innovative

For **all**

Presentation overview

- Project goals
- Background, progress & status
- Updated design overview
- Other walking/biking investments in Northgate
- Next steps
- Feedback/Q&A



Project goals

- Connect services and opportunities on the east and west sides of I-5
- Add a new, accessible walking/biking route in Northgate that connects to the citywide network
- Provide better access to regional transit, including the existing transit center and future Link light rail station



Project area



Background, progress & status

- 2006: Northgate Coordinated Transportation Investment Plan
- 2012: King County feasibility study
- 2014: Early planning and design
 - 3 bridge alternatives
 - Public meeting
- 2015: 30% design
 - Public meeting
- 2016: Project put on hold
 - Independent cost validation
 - Formed new project team
- 2017: New 30% design



Previous design



Other cost-saving changes

Original Design	Revised Design
20-foot-wide walkway on bridge	16-foot-wide walkway on bridge
East approach conflicted with WSDOT Park-and-Ride at 1st Ave NE	East approach modified as it touches down near 1st Ave NE, simplifying the connection and preserving the WSDOT Park-and-Ride lot
West approach included stairs at the North Seattle College, with limited sight distance	West approach modified to improve sight distances and make a more direct connection
Complicated construction approach	Standard construction approach to reduce project duration
Tube/truss design (enclosed)	More open structure and more graceful bridge transition

A more direct connection

- Length of bridge:
Reduced from 2100 to 1580 feet
- East approach reconfigured to provide safer ped/bike experience
- **Bridge slope:** ramps changed from 4.8% to 8.3% slope.
 - Meets ADA requirements
 - 5-ft landings every 30 feet

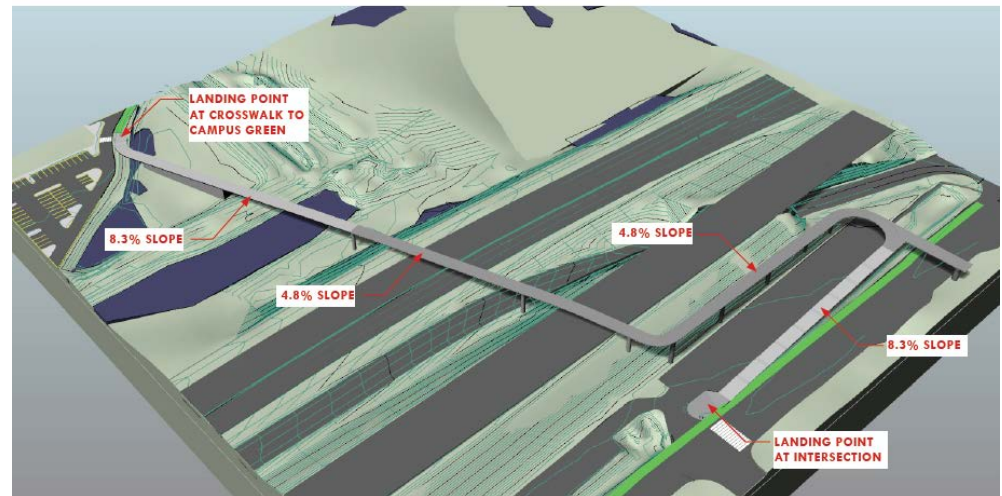
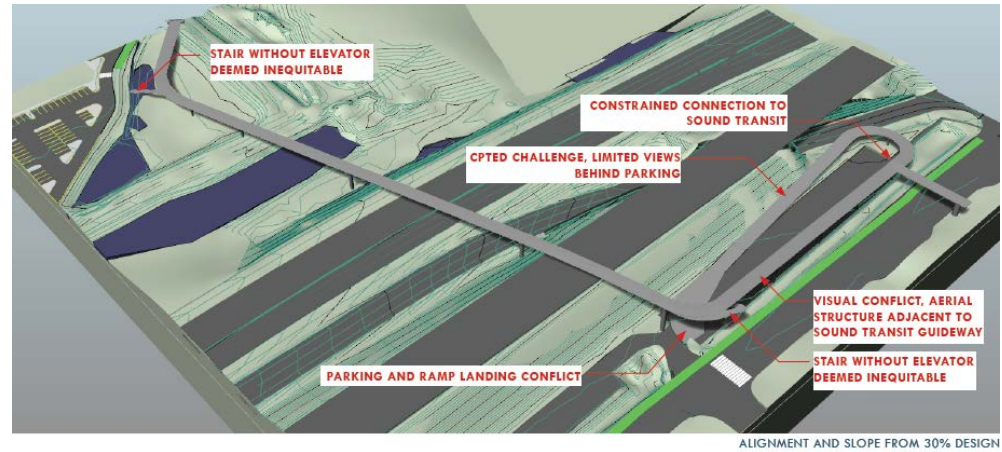

Bridge slope

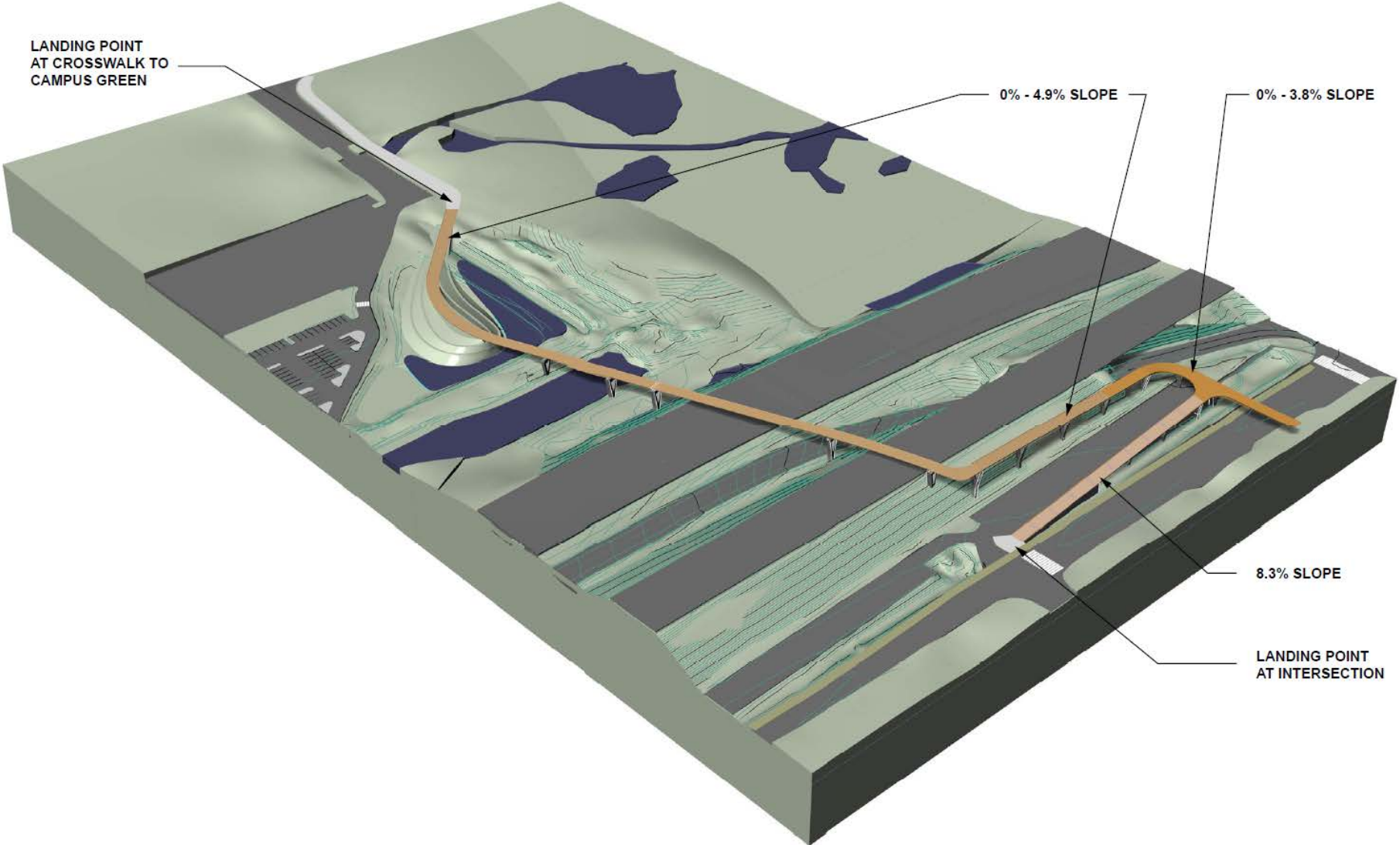

Revised bridge design

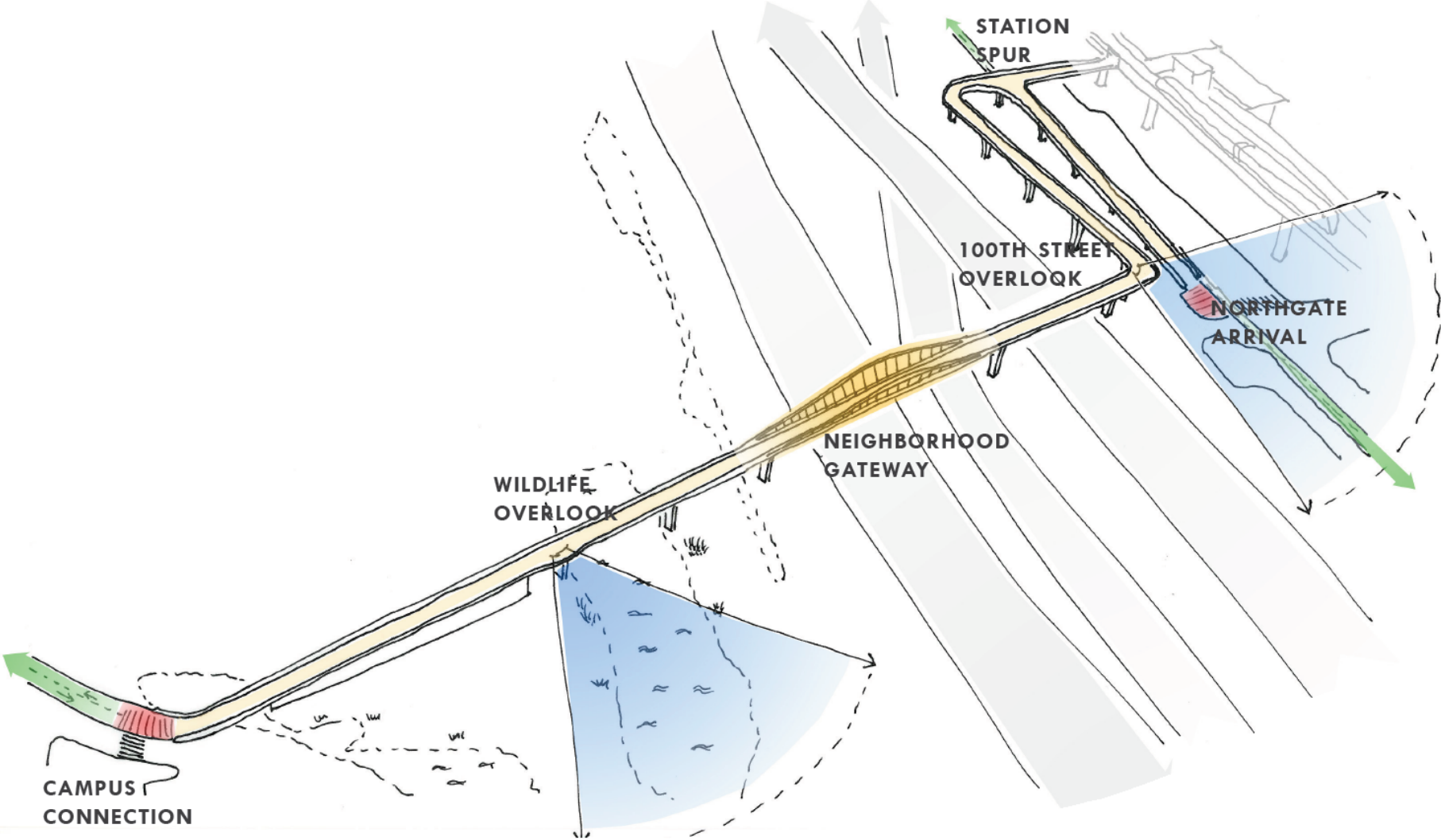

Paving and transitions

- Paving as key intuitive wayfinding element of the main trail
- Variations in paving used to communicate mixing areas and transitions

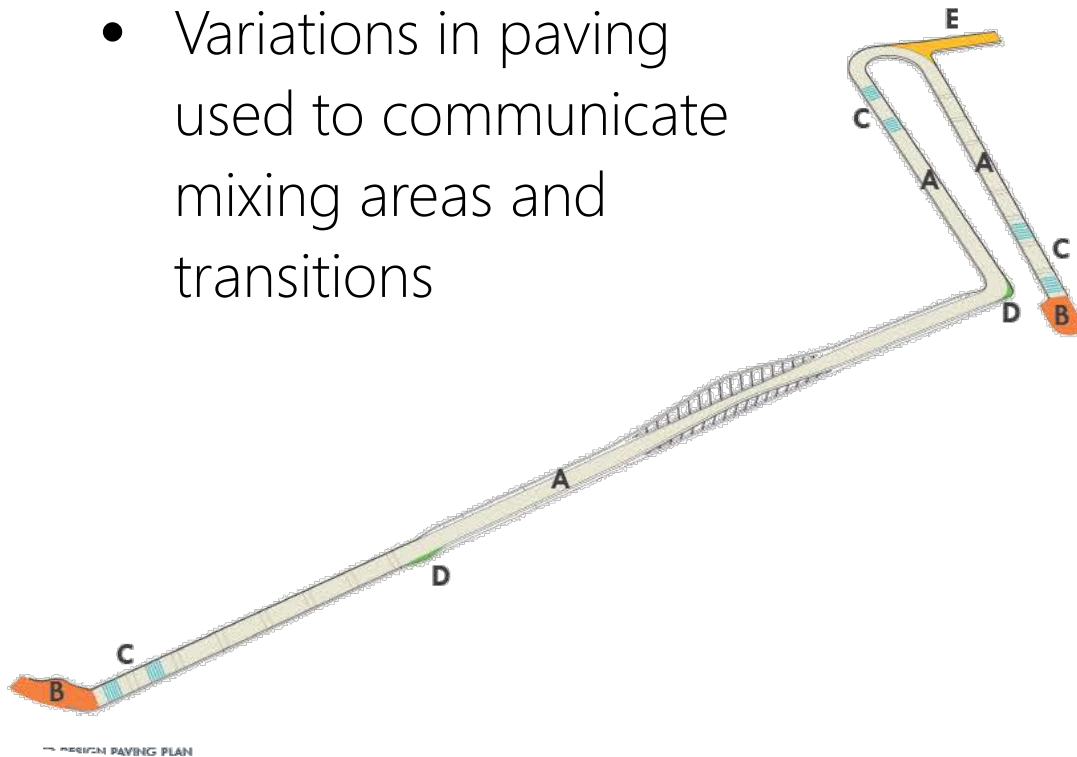

DESIGN PAVING PLAN

A Main Trail	-Lightly Broomed Concrete	
B Mixing Zone	-Concrete Pavers	
C Rumble Strips	-Embedded Striping	
D Outlook	-Pigmented Concrete	
E Spur Bridge	-Pigmented Concrete	

Open truss design

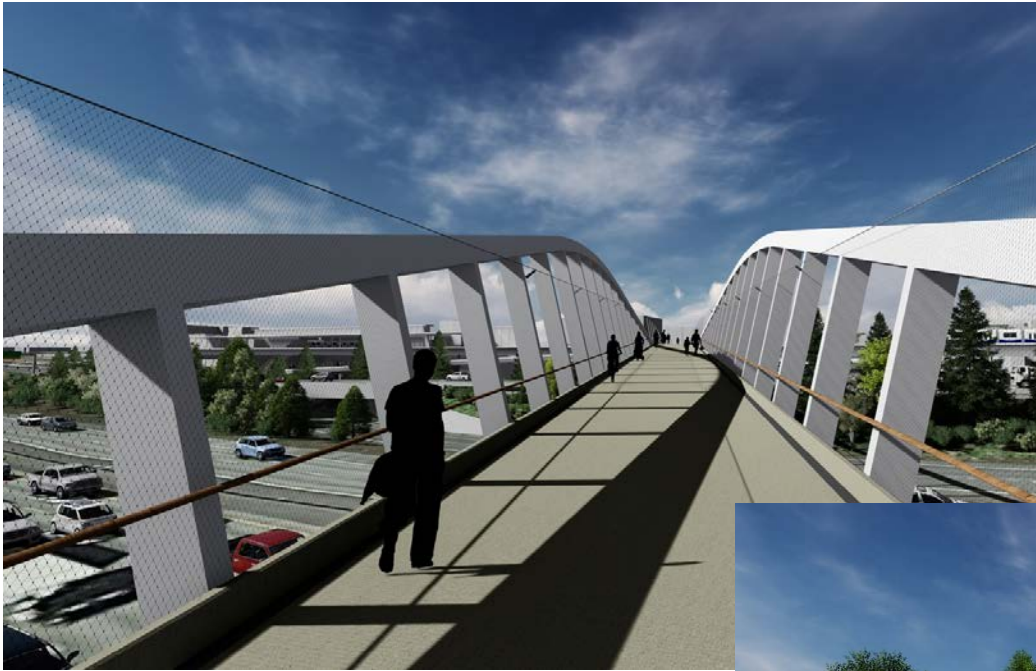

Campus connection (west approach)

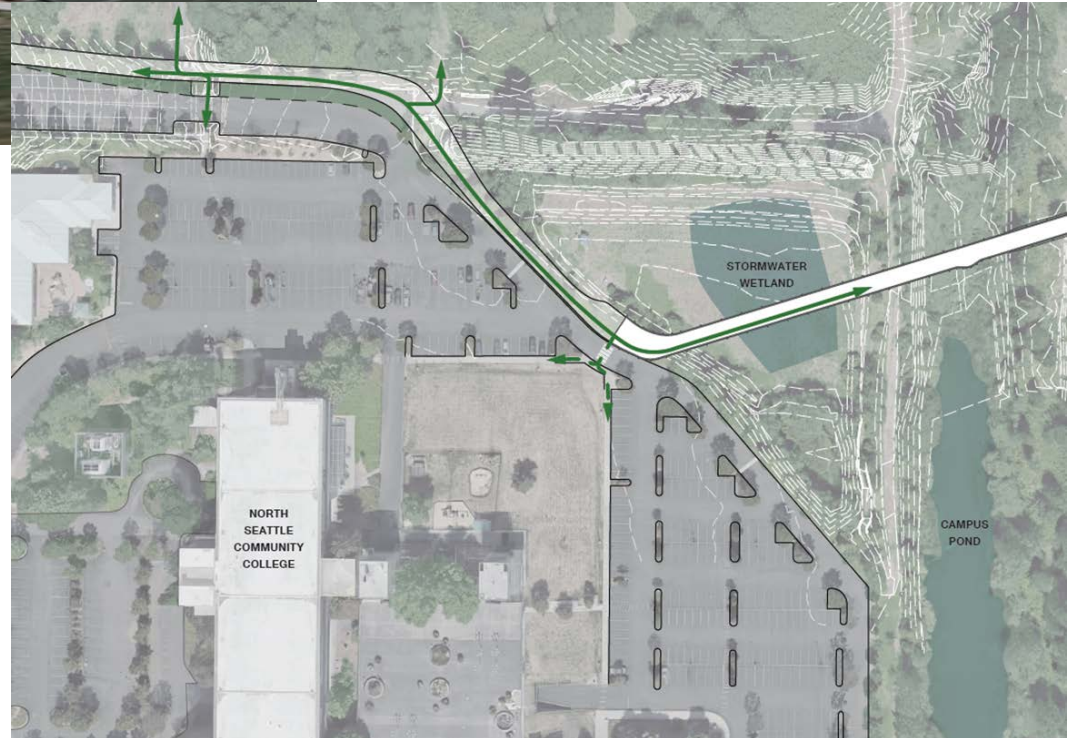

I-5 gateway



NE 100th St overlook

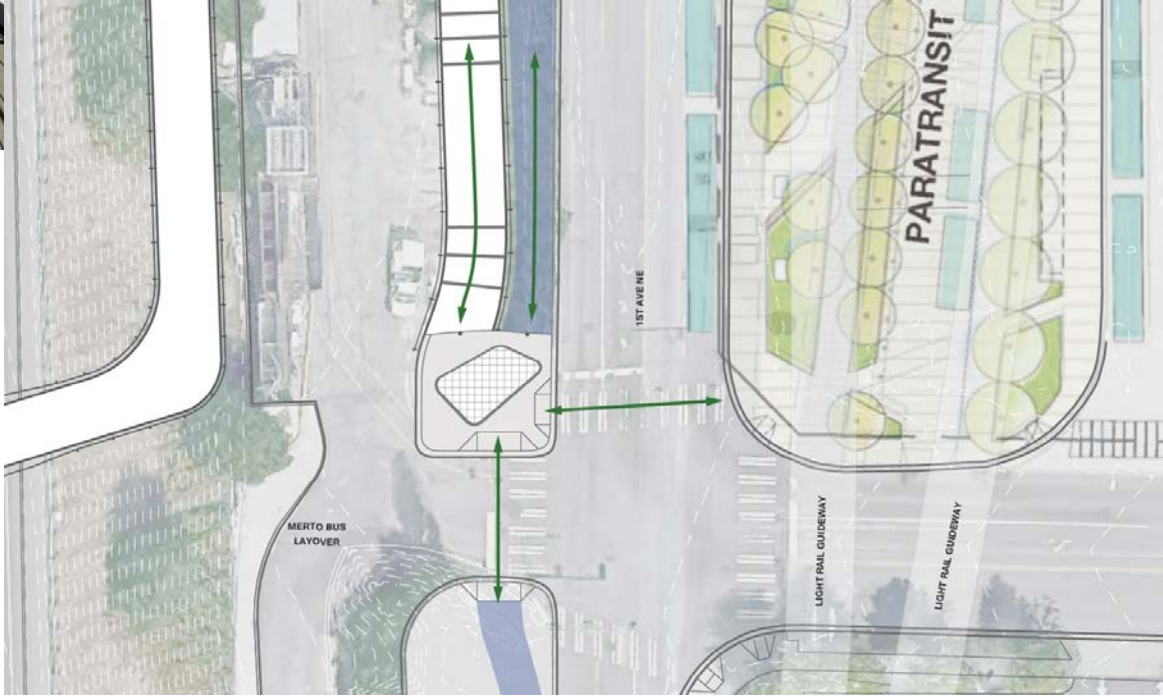
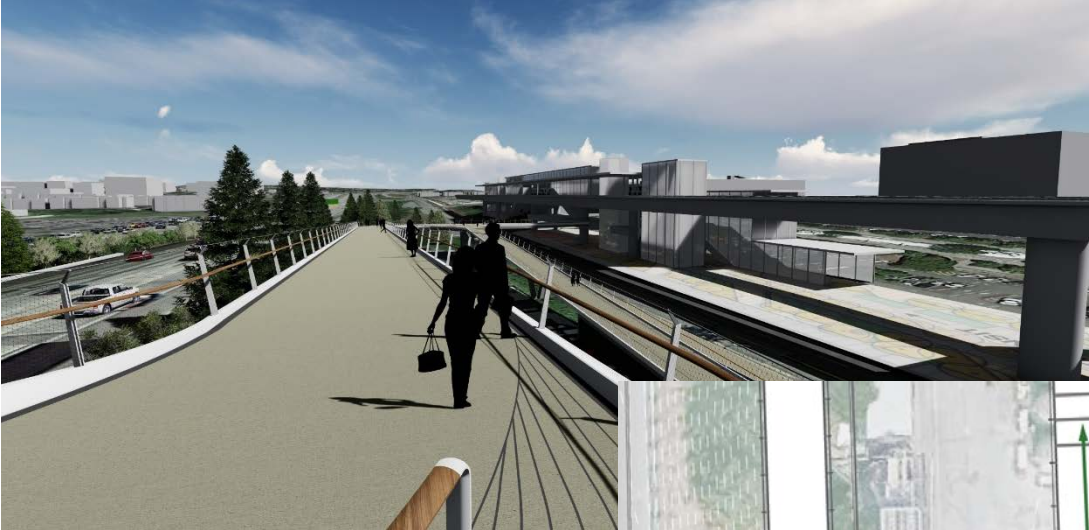

Animation

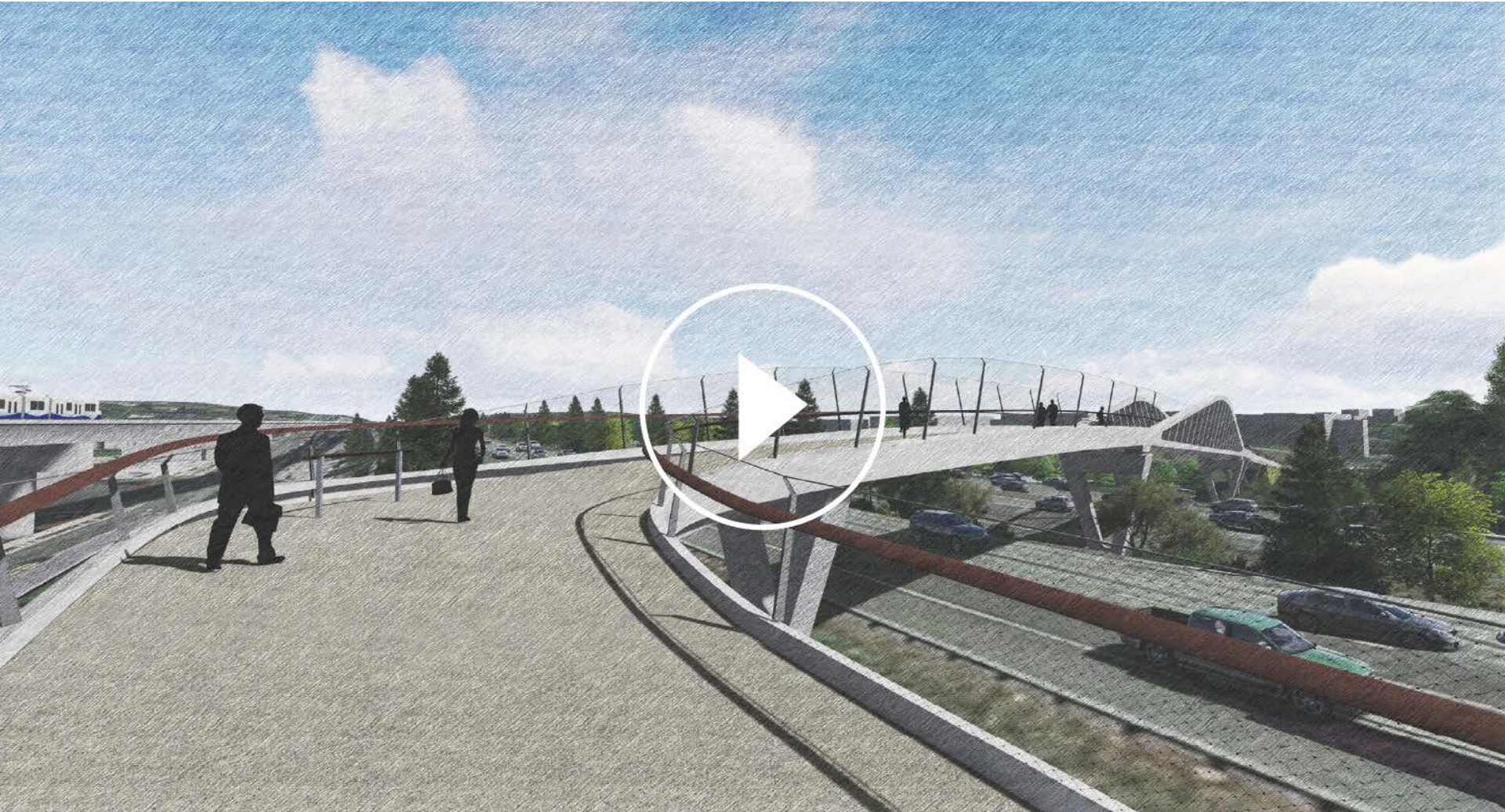

Pedestrian Projects

- 1 Northgate Pedestrian & Bicycle Bridge
- 2 1st Ave NE multi-use path (NE 92nd St to Northgate Way)
- 3 Improved sidewalks (Station to 5th Ave NE)
- 4 Protected Bike Lane NE 92nd St (Wallingford Ave N to 1st Ave NE)
- 5 Crossing improvements (N Northgate Way and Corliss Ave N)
- 6 Streetscape & bike improvements (1st Ave NE to 5th Ave NE)
- 7 New sidewalk NE 95th St (1st Ave NE to 5th Ave NE)
- 8 New sidewalk NE 98th St (5th Ave NE to 8th Ave NE)
- 9 Crossing improvements (5th Ave NE and NE 95th St)
- 10 North Seattle Greenway (Crown Hill to Northgate Pedestrian & Bicycle Bridge)

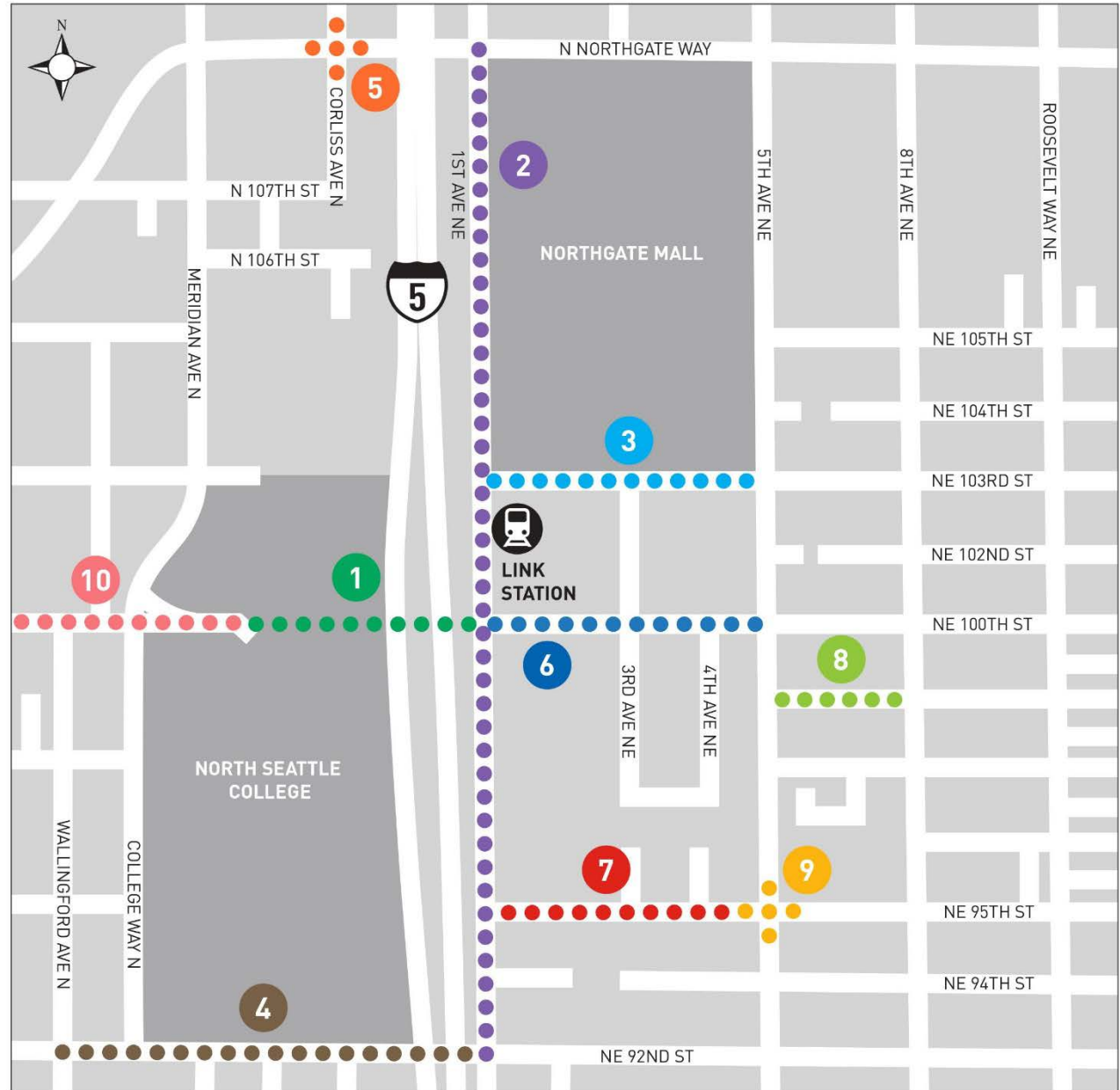

Next steps: Northgate Bridge

Time frame	Activity/action
Summer 2017	Share revised design <ul style="list-style-type: none">• Community briefings• Public events• Agency coordination
Fall 2017	Federal and state environmental review and outreach process
Late 2017/early 2018	Design update and outreach
Summer 2018	Design complete

Next steps: Northgate Bridge

Time frame	Activity/action
2019	Construction begins
2020	Bridge opens before light rail station
2021	Link light rail station opens



Questions?

Project Team

NorthgateBridge@seattle.gov | (206) 615-0925
www.seattle.gov/transportation/northgatepedbridge.htm

www.seattle.gov/transportation



Seattle
Department of
Transportation